



Tow-Trust Towbars

Important: Please read General Notes overleaf before fitting

Issue 2

TT200 TOYOTA PRIUS III CYCLE MOUNT

Item	Qty	Description	Item	Qty	Description
A	1	Crossmember	B	2	M16 x 40 Bolts, Nuts & S/P Washers
			C	4	M12 x 40 x 1.25 Bolts & S/P Washers
			D	4	Disk Spring Washers

NOTE: THIS IS NOT A TOWBAR AND IS ONLY SUITABLE FOR CYCLE CARRIERS WITH A MAX NOSE LOAD OF 50 Kg

1. Remove the two fixing bolting the Towing eye from the L/H chassis member and discard bolts.
2. Remove the two fixings bolting the exhaust bracket to the R/H chassis member and discard the bolts. NOTE: support the exhaust silencer to prevent damage.
3. Feed cycle mount through the aperture in the plastic under shield up to mounting point on the L/H chassis member and loosely fix in place with items C and D.
4. Using item C with item D bolt the remaining two fixings on the R/H side of vehicle sandwiching the cycle mount between chassis and exhaust bracket.
5. Using item B bolt your desired cycle carrier mount to face plate.
6. Fully tighten all nuts and bolt ensuring all frame work is rigid square and secure.

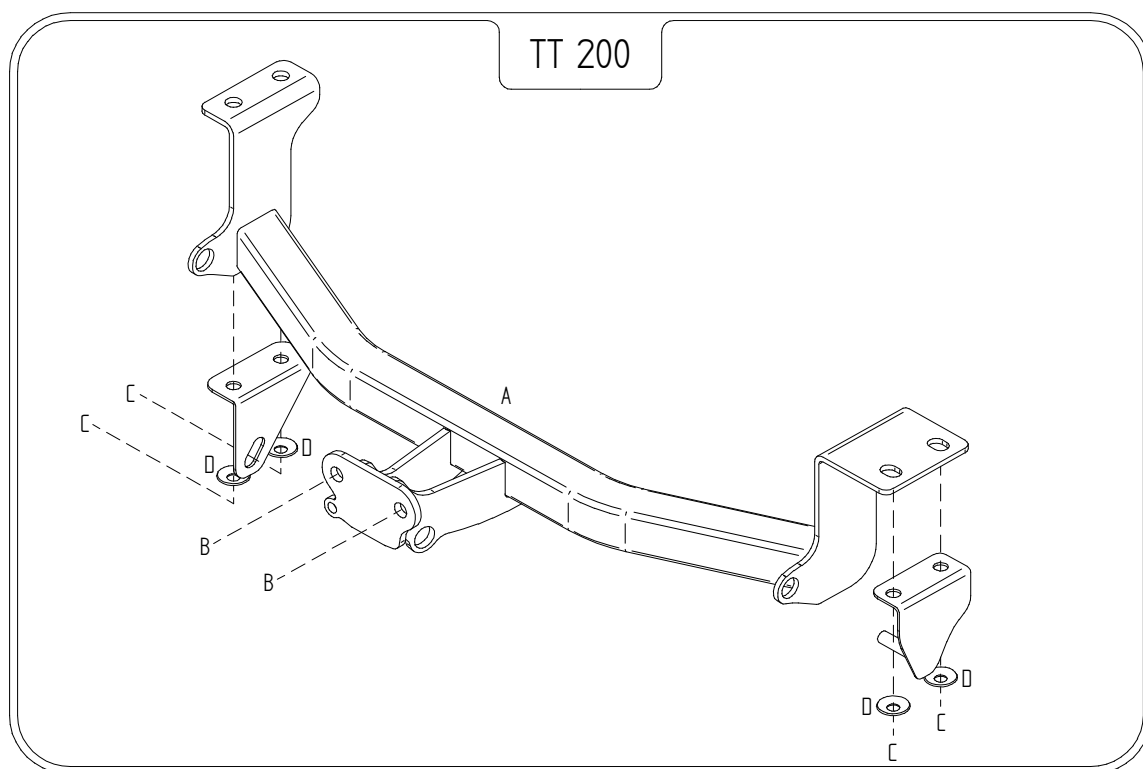

Note:

1. Recommended Torque Setting for M12 Grade 10.9 -139 Nm. (For other Torque Settings see notes overleaf.)
2. Nose load limits and vehicle manufacturer's weight limits must be observed.